

CONSUMABLES



HEAVY DUTY DRILLING VALVES AND SEATS

GD Energy Products' Heavy Duty Valves & Seats are designed for maximum performance and reliability in drilling applications. Our full-open, bonded design provides optimal flow efficiency and maximum sealing. Featuring a proprietary urethane blend, our API 6 and API 7 valve is a field proven performer in temperatures up to 280°F.

Manufactured in the USA, GD Energy Products' Heavy Duty Valves and Seats have outperformed the competition in numerous basins. Compatible with both oil and water-based drilling muds, our "deep groove", two-piece fused-body valve design contains additional urethane for improved durability and extended life.

Our Redline Series of drilling pump consumables serve as the perfect complement to our performance-proven drilling pumps and competitor pump models. With our "ready inventory" promise, our Redline drilling pump consumable products are readily available and offer unparalleled quality and reliability.

FEATURES & BENEFITS

- Rated for pressures up to 7500 psi and 280°F
- Full open design for max flow efficiency
- Compatible with Oil & Water-based muds
- Abrasion and chemical resistant
- Available in both standard and modified API 6 and API 7 sizes
- Manufactured in USA
- Two Piece Fusion Welded Valve Body



HEAVY DUTY DRILLING VALVES AND SEATS

SPECIFICATIONS

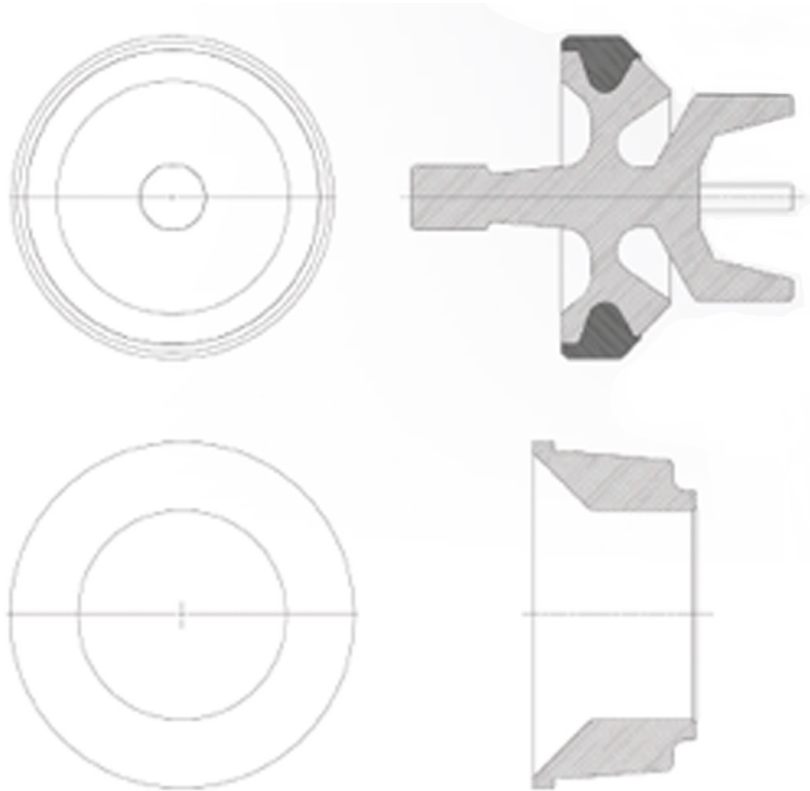

API 6 VALVE ASSEMBLY PART #'S

Valve	329PZL482
Seat	305PZL039
Spring	301PZL105

API 7 VALVE ASSEMBLY PART #'S

Valve	319PZL482
Seat	304PZL039
Spring	300PZL105