

CONSUMABLES



EXTREME DUTY DRILLING VALVES AND SEATS

GD Energy Products' Extreme Duty Drilling Valves and Seats are designed for maximum performance and reliability in drilling applications. Our full-open, bonded design provides optimal flow efficiency and maximum sealing. Featuring a new proprietary high endurance urethane, our API 6 and API 7 valves are field proven performers in temperatures up to 350°F.

Manufactured in the USA, GD Energy Products' Extreme Duty Drilling Valves and Seats have outperformed the competition in numerous basins. Compatible with both oil and water-based drilling muds, our "deep groove", two-piece fused-body valve design contains additional urethane for improved durability and extended life.

Our Redline Series of drilling pump consumables serve as the perfect complement to our performance-proven drilling pumps and competitor pump models. With our "ready inventory" promise, our Redline drilling pump consumable products are readily available and offer unparalleled quality and reliability.

FEATURES

- Rated for pressures up to 7500 PSI and 350°F
- Full open design for max flow efficiency
- Compatible with Oil & Water-based muds
- Abrasion and chemical resistant
- Available in both standard and modified API 6 and API 7
- Manufactured in USA
- Two Piece Fusion Welded Valve Body



EXTREME DUTY DRILLING VALVES AND SEATS

SPECIFICATIONS

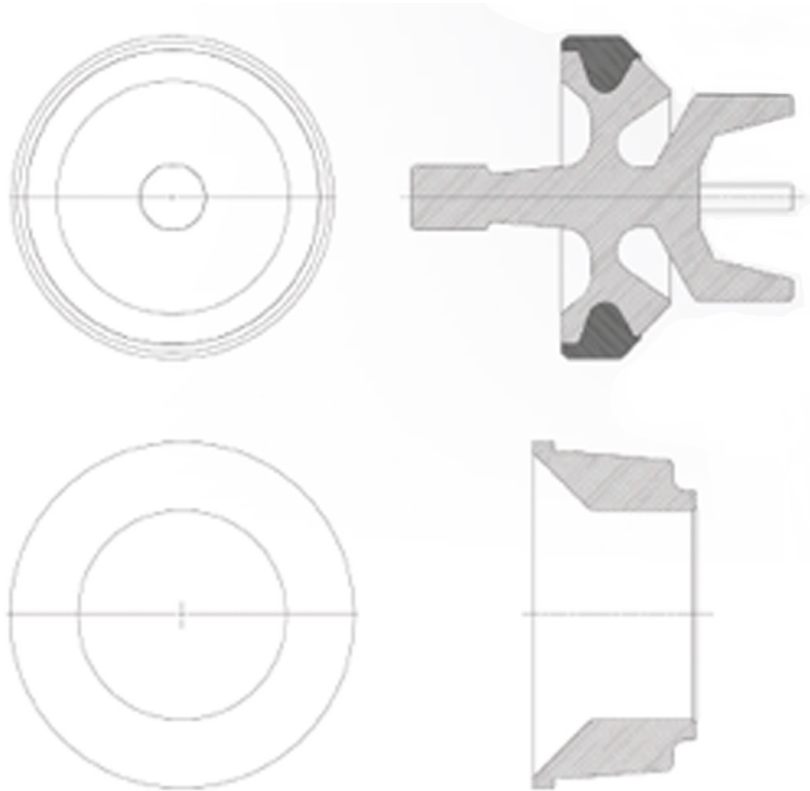

BENEFITS

- Supreme performance and reliability in ultra-high temperature environments
- Longer lasting expendables
- Reduction in overall cost due to lower inventory and consumption rates
- Less unscheduled maintenance improving overall safety
- Compatible with both GDEP and competitor pumps

API 6 VALVE ASSEMBLY PART #'S		API 7 VALVE ASSEMBLY PART #'S	
Valve	333PZL482	Valve	334PZL482
Seat	305PZL039	Seat	304PZL039
Spring	301PZL105	Spring	300PZL105